

REV	ECN. NO.	APP.	DATE
A	NEW DESIGN		

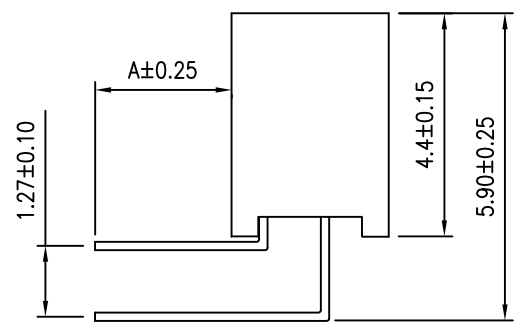
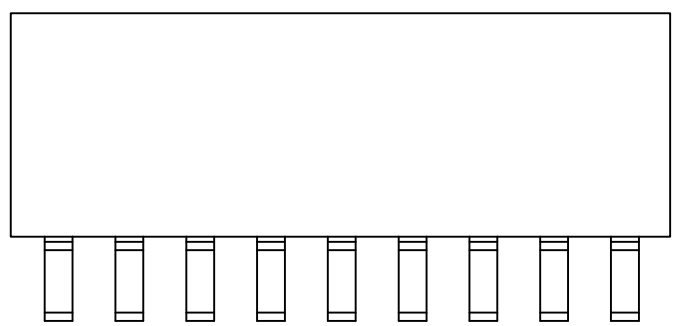
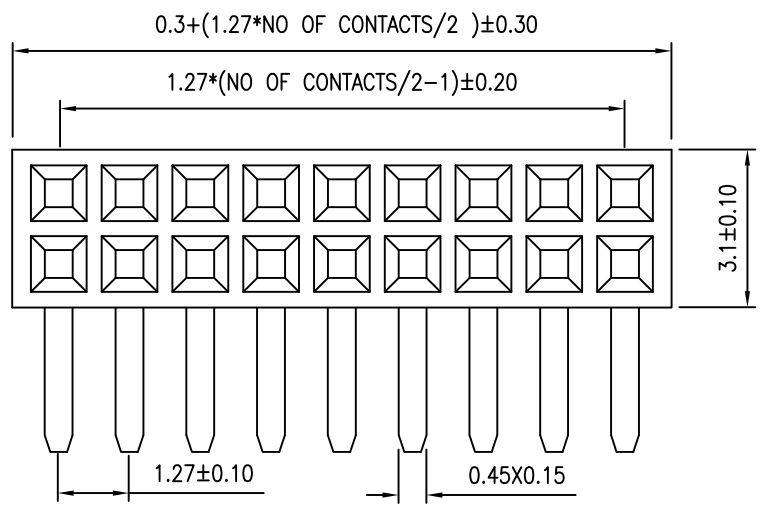

SPECIFICATION

- \* Current Rating: 1 A
- \* Withstanding Voltage: 300 VAC ( 1 min. )
- \* Insulation Resistance: 1000 Megohms MIN.
- \* Contact Resistance: 30 Milliohms MAX.
- \* Operating Temperature: -40°C to +105°C

ORDER INFORMATION

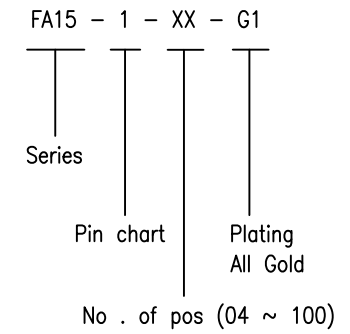

MATERIAL

- \* Contact: Phosphor Bronze
- \* Insulator: PA6T + 30% G.F.
- \* Plating: All Gold

Pin Chart

Pin	A
1	2.60

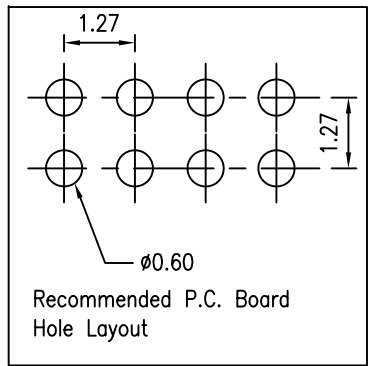

(주)신화테크 SHINHWA TECH CO.,LTD  
 TEL : 031-451-9441 FAX : 031-451-9444

0.0±	SCALE:	TITLE:	PART NO:
0.00±	UNIT: MM	1.27MM Female Header	APP BY:
0.000±		Dual Row Right Angle	CHK BY:
		MATL: PA6T + 30% G.F.	DR BY:
		DWG NO: FA15	